

LuerSite Valve

DESCRIPTION

m|devices LuerSite Valve is designed for use with luer lock and luer slip connectors. One small push ensures a firm connection even with luer slip syringes. A closed silicone diaphragm stops flow until mechanically opened with a luer device. The LuerSite allows for a bi-directional flow of up to 345mL/min upon actuation.

FEATURES & BENEFITS

- Needleless valve
- Bi-directional flow upon actuation
- Low priming volume
- Transparent housing for clear visibility

PRODUCT DATA

- Flow rate: 375mL/min
- Number of accesses:
Tested up to 100 times
- Priming volume: 0.14mL
- Pressure rating: 45 Psi
- Lipid resistant
- ARTG Number: 272194
- The product is MRI and CT suitable
- Not made with DEHP
- Not made with Natural Rubber Latex
- Material: PC, ABS, Silicone, PE
- Shelf Life: 5 Years

ISO STANDARDS

TBC

PRODUCT DIAGRAM

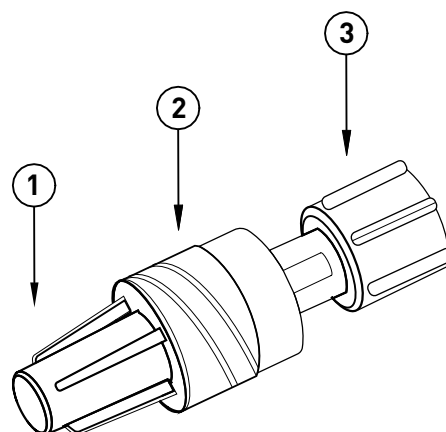

| ITEM | DESCRIPTION |
|------|-------------|
| 1 | Upper cover |
| 2 | Valve |
| 3 | Lower cover |

Luer Activated Valve

STERILE

| RE-ORDER | DESCRIPTION | CARTON/QTY |
|----------|----------------|------------|
| IV200001 | LuerSite Valve | 50 |